

WE OPEN SPACE



Roto NT

Tilt & turn hardware

Tilt first, 'R' hinge

Parts brochure & fitting instructions

Product liability guidelines	4
General design description	5
Tilt first, 'R' hinge standard gearing	6
Tilt first, 'R' hinge standard parts list	7
Tilt first, 'R' hinge security gearing	8
Tilt first, 'R' hinge security parts list	9
Sash preparation	10
Hinging and unhinging the sash	11
Installation and adjustment information	12
Locking cam options and adjustment	13
Maintenance	14
Operating and safety instructions	15

Roto NT

Product liability & warranty

Turn-Only and Tilt & Turn Hardware for windows and balcony doors

According to the defined manufacturer's liability described in paragraph 4 of the "product liability law", the following information regarding Turn-Only and Tilt & Turn Hardware for window and balcony door sashes should be observed. Non-compliance exempts the manufacturer of his liability.

1. Product information and specified application.

Turn-Only and Tilt & Turn Hardware as covered by this definition is one-hand-operation Turn-Only and Tilt & Turn Hardware for windows and balcony doors in building construction. This is used to enable windows and balcony-door sashes into a turning position by operating a 'hand lever' (handle) or into a limited tilting position in the case of the scissors (sash-stay) version.

Turn-Only and Tilt & Turn Hardware is used on vertically installed windows and balcony-doors made of timber, PVC, aluminium or steel and their corresponding material combinations. Conventional Turn-Only and Tilt & Turn Hardware as covered by this definition, lock window and balcony-door sashes and enable various ventilating positions. When closing, the gasket counter force must be overcome as a rule.

Differing applications do not correspond to its specified application. Burglar-resistant window and balcony doors, window and balcony doors for damp rooms and those for use in environments with aggressive, corrosive air content, require hardware adapted for the respective application and individually agreed upon performance features.

Opened windows and balcony-door sashes achieve only a shielding function and do not meet any demands on joint impermeability, water tightness, sound reduction, heat insulation and burglary resistance.

In the case of wind and draught, the window and balcony-door sashes must be closed and locked. Wind and draught as covered by this definition is present, if a window or balcony door sash while in one of its opening positions, can open or close on its own, in an uncontrolled manner by means of either air pressure or air suction. A static opening position of windows and balcony door sashes can only be achieved with additional hardware. The resistance against wind loads in a closed and locked state is dependent on the respective designs of windows & balcony doors. Should wind loading in accordance with DIN EN 12210 occur (in particular pressure test p3), suitable hardware compilations are to be matched in relation to the respective window design and frame material, and each case individually agreed upon.

Generally speaking, Turn-Only and Tilt & Turn Hardware can fulfil the demands made for barrier-free dwellings according to DIN 18025. However corresponding hardware compilations and installations for windows and balcony doors are necessary, which must be coordinated and each case individually agreed upon.

2. Misuse

Misuse - therefore not the specified product utilisation - of Tilt & Turn hardware for windows and balcony doors occurs in particular:

- if obstacles are inserted in the opening vicinity between frame and sash, thus preventing its proper specified use.
- when window and balcony door sashes are pressed advertently or uncontrolled (for example by the wind) up against the window reveals, so that the hardware, the frame material or other individual window or balcony-door sash components are damaged or destroyed and/or if consequential damage can arise.
- if additional loads are put on windows or balcony-door sashes (for example if children swing on the window or balcony door sash),
- if while closing the windows and balcony door sashes, someone reaches into the rebate between the sash and frame (injury hazard).

3. Liability

The respective entire hardware set may only consist of hardware components from Roto's outward opening range. In the case of inappropriately assembled hardware, and/or in case of non original accessory components and/or non factory-approved accessory components, no liability is accepted.

4. Product performance

4.1 Maximum sash weights

The following listed maximum sash weights for the individual hardware versions may not be exceeded. The building component with the least permissible load-carrying capacity determines the max. sash weight. Application diagrams and component allocation are to be observed.

4.2 Sash sizes

The presentation of the application diagrams shows the relationships between the permissible sash rebate widths and sash rebate heights, depending on various glass weights and/or thickness'. The resulting sash rebate dimensions or sash formats (portrait and/or landscape format) - as well as the maximum sash weight - must not be exceeded under any circumstances.

4.3 Hardware-combination

The manufacturer's regulations that deal with the combination of hardware are obligatory. (for example: the application of additional stay arms, the hardware design for burglar-resistant window and balcony-door sashes).

5. Product maintenance

Security relevant hardware components are to be examined at least once a year for stability and wear and tear. Depending on the requirements, the fixing-screws are to be tightened and/or parts exchanged. In addition to this, the following maintenance work is to be carried out annually:

- All movable parts and all locking points of the Turn-Only and Tilt & Turn Hardware are to be greased and tested.
- Only cleaning and maintenance agents which do not damage the corrosion protection of the hardware components are to be used.

The hardware adjustments - particularly in the vicinity of the corner pivot rest and the scissors - as well as replacing parts and the unhinging & hinging of the active sash are to be carried out by a specialist company.

When surface treating - for example when painting or varnishing - the windows' and balcony doors hardware is excluded from this process and is also to be protected against any impurities (paint/varnish splashes).

5.1 Retention of the surface quality

Electrolytically applied zinc coatings are not attacked in a normal room climate, when no condensation can form on the hardware or occasionally formed condensation can dry rapidly.

In order to permanently preserve the hardware's surface quality and to avoid deterioration by corrosion, it is imperative to observe the following points:

- The hardware and/or the rebate areas are to be ventilated sufficiently in particular during the building phase so that they are not exposed either to direct wetness or condensation.
- The hardware is to be kept free from deposits and soiling from building materials (building dust, plaster, cement etc.).
- Aggressive vapours in the rebate area (for example: through formic acid or acetic acid, ammonia, amine or ammonia compounds, aldehydes, phenols, tannic acid etc.) in connection with small formations of condensation can lead to fast corrosion of the hardware. In the case of such aggressive vapours occurring, a general adequate ventilation of the rebate areas of windows and balcony doors is to be ensured. This is particularly valid for windows and balcony doors made of oak or other types of timber with a high concentration of (tannic-) acid.
- Furthermore no acetic-acid or cross-linked acidic sealing compounds or those with the above mentioned contents may be used, since both the direct contact with the sealing compound and its vaporisation can attack the surface.
- The hardware may only be cleaned with mild, pH-neutral cleaning agent in diluted form. Under no circumstances may aggressive, acidiferous cleaners or abrasive cleaning agents whose contents are listed in the above paragraph be used.

6. Obligation to issue information and instructions

To fulfil the information and instruction obligations as well as the maintenance operations according to the "product liability law", the following is available:

- for planning engineers "planning documents" for authorised dealers "catalogues"
- for fabricators "installation instructions" and "factory drawings"
- for builders and end users: "service Et maintenance instructions" as well as "Operating manuals".

In order to safeguard the function of Turn-Only and Tilt & Turn Hardware for windows and balcony doors:

- Planning engineers are obliged to request and comply with the manufacturers or authorised dealers product information.
- The authorised dealers are obliged to observe and request product information from the manufacturer and to pass this on to the fabricators, in particular installation instructions, factory drawings, service Et maintenance instructions as well as operating manuals.
- Fabricators are obliged to observe the product information and in particular to request service & maintenance instructions as well as operating manuals from the manufacturer or authorised dealer, and to pass these on to the builders and end users.

7. Applicability for related hardware

The variations possible within the individual hardware system - for example Tilt-only and Top-hung hardware - are to be treated according to the corresponding valid features of product performance, product maintenance, information and instruction obligations, product information, specified use/application and misuse.

General design description



The general design description lists characteristics of the Roto NT, R hinge, tilt and turn window hardware:

- Designed for use on all timber, PVC-U and aluminium windows with a standard eurogroove.
- Faceplate width 16mm.
- All cams are adjustable by +/-0.8mm, meaning adjustments can be made on site.
- 3 locking cam versions. NT components listed here feature 3 different locking cam options that differ in application and adjusting capabilities. Detailed adjusting information can be found on page 13.



Locking cam E
Compression adjustable



Locking cam P
Compression adjustable security cam



Locking cam V
Height and compression adjustable security cam

- Precision design ensures smooth performance in all applications.

Coating specification

RotoSil surface protection procedure has been developed by Roto for the hardware product range, based upon galvanising, chromating and an additional sealing. RotoSil enables the hardware components to appear in a smooth silver tone. The quality requirements of RAL-RG 607/3 are exceeded, also the protection effect against acids has been decisively improved. The surface protection regulations of the RAL quality assurance association in Velbert, Germany, are more than fulfilled.

Surface protection with RotoSil exceed the requirements of the following standards:

RAL 607/3 (72 hours protection from white rust and 240 hours protection against red rust. Inclusive of cycle testing to 60,000 cycles).

BS 6375 pt. 2 "Performance of Windows."

BS EN 1670:2007 part 5.6, grade 5
(480 hours building hardware corrosion resistance).



Viewed from the inside

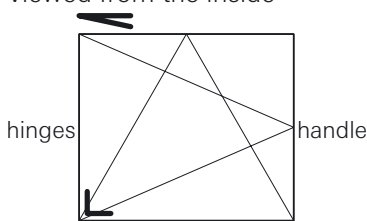

Roto NT

Tilt first, 'R' hinge

Standard gearing

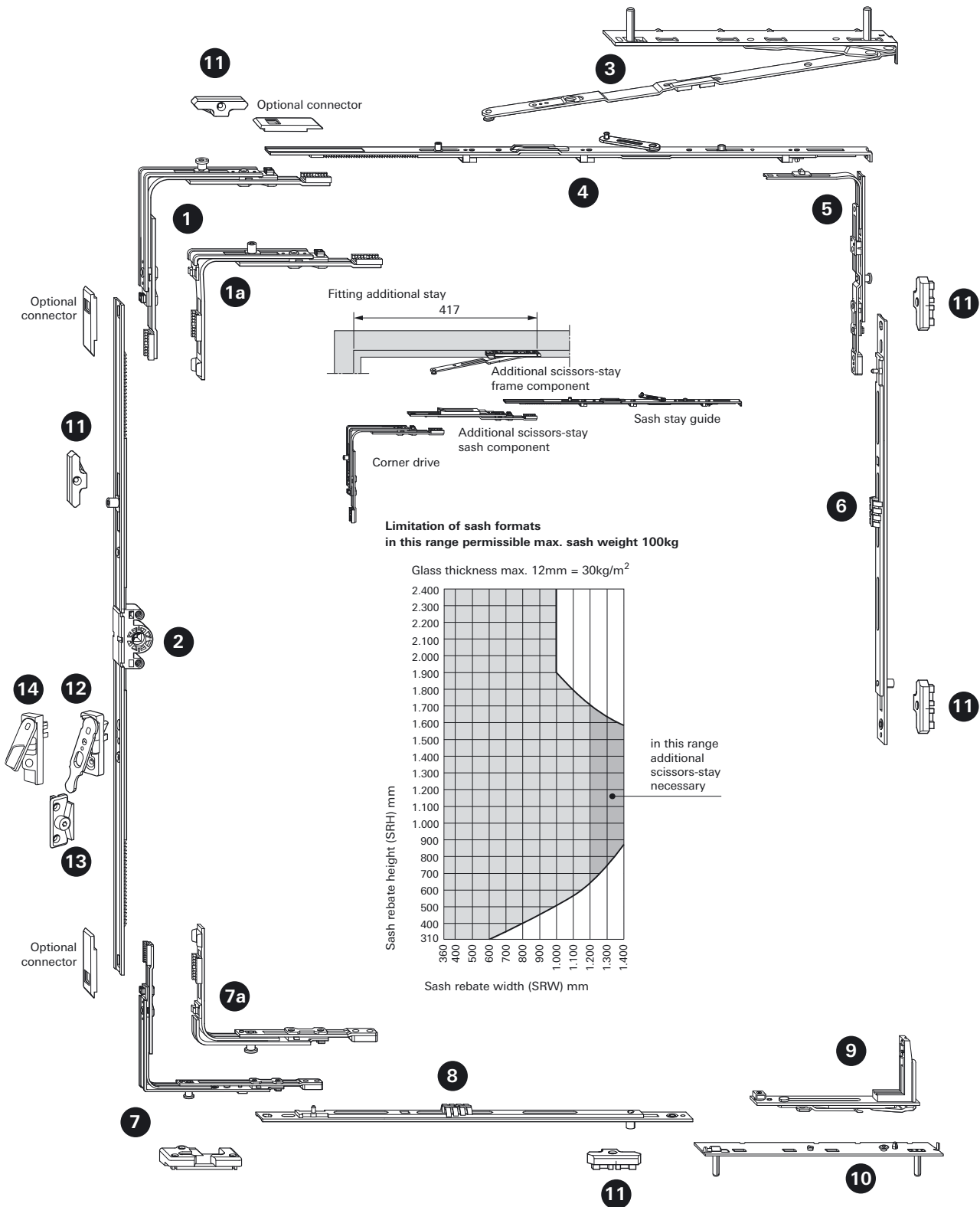

Application range

Sash rebate width, min. - max. 360 - 1400mm

Sash rebate height, min. - max. 310 - 2400mm

Sash weight, max. 100kg

Optional connector 350 401

Tilt first, 'R' hinge Standard parts



Corner drives

Item number		SRH	Part Number
1	1 P	451 - 2400	260 277
1a	1 E	310 - 450	260 280

2. Espagnolette

SRH	Length (mm)	Part Number
310 - 450 ⁽¹⁾	430	259 717*
451 - 620	400	259 718*
621 - 800 1 E	580	259 719
801 - 1200 1 E	980	259 720
1201 - 1600 2 E	1380	259 721
1601 - 2000 2 E	1780	259 762
2001 - 2400 4 E	2180	259 763

* Lifting & mishandling device is not possible

⁽¹⁾ With special corner drive 1a & TF corner drive 7a

3. Royal stay arm

SRW	Part Number
360 - 800	L Profile related R Profile related
801 - 1400	L Profile related R Profile related

4. Royal stay guide

SRW	Length (mm)	Part Number
360 - 410	300	253 811
411 - 600	490	253 812
601 - 800	690	253 813
801 - 1000 1 E	890	253 814
1001 - 1200 1 E	1090	253 815

Additional stay **292 022** is required on sashes over 1200mm wide, increasing the maximum sash rebate width to 1400mm.

Additional **profile related** packer is required.

5. Centre lock stay guide connector 1 **P** 280 836

6. Standard centre lock (vertical)

SRH	Size	Part Number
801 - 1200 1 E	400	255 280
1201 - 1400 1 E	600	255 281
1401 - 1800 1 E	600 connectable	255 282
	400	255 280
1801 - 2000 1 E	600 connectable	255 282
	600	255 281
2001 - 2400 2 E	600 connectable	255 282 x 2
	400	255 280

Tilt first corner drives (for tilt first window only)

Item	Description	Part Number
7	Tilt first corner drive 1 P	260 277
7a	Special TF corner drive 1 P	260 282

Tilt first striker **Profile related**

Special TF corner drive 7a should be used to achieve a SRH of 310mm

8. Standard centre lock (horizontal)

SRW	Size	Part Number
801 - 1200 1 E	400	255 280
1201 - 1400 1 E	600	255 281

9. Royal corner hinge

Max. sash weight	Part Number
100 kg	L 254 026 R 254 028

10. Royal pivot rest

Max. sash weight	Part Number
100 kg	Profile related L/R

11. Compression striker **Profile related**

12. Sash lifting device 260 538

13. Striker for sash lifting device **Profile related**

14. Mis-operation device

	Part Number
9mm axis	L 349 128 R 349 129
13mm axis	L 349 130 R 349 131

Locking cam **E** Compression adjustable cam

Locking cam **P** Compression adjustable, security cam

Roto NT

Sash preparation

Routing gearbox

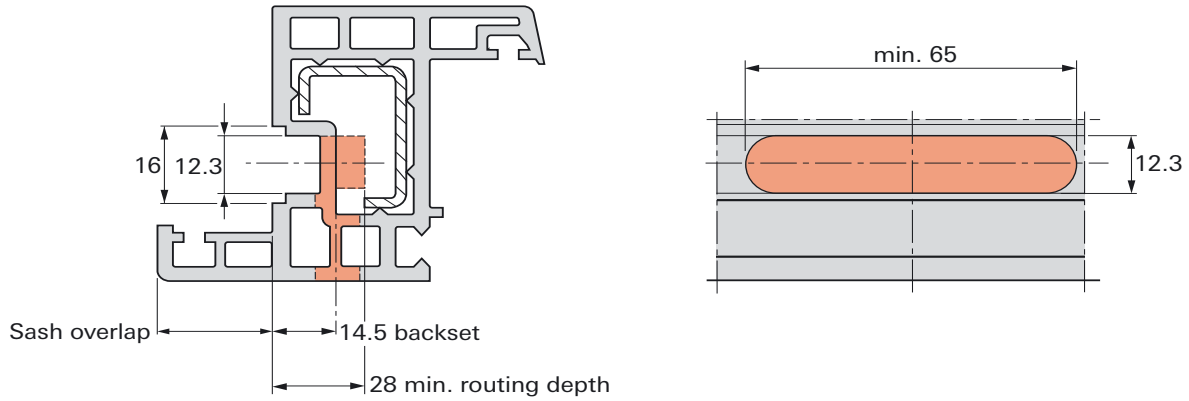

Handle drilling & mounting

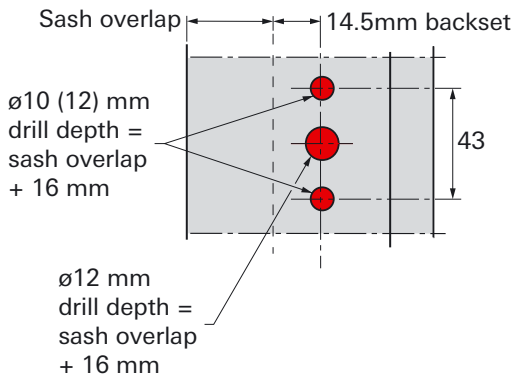

Fix the window-handle with $\varnothing 5$ mm countersunk screws DIN965 (M5 X ...) in the espagnolette gear casing.

RotoLine window handle with lugs & 7mm spindle

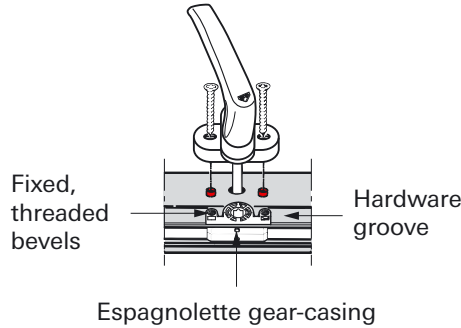

Cropping extensions

When cropping manually, the extension(s) should be cut so as to allow a gap of 33mm between the ends of the faceplates as shown.

This gap is then bridged using a dedicated connector piece.
Part number **350401**

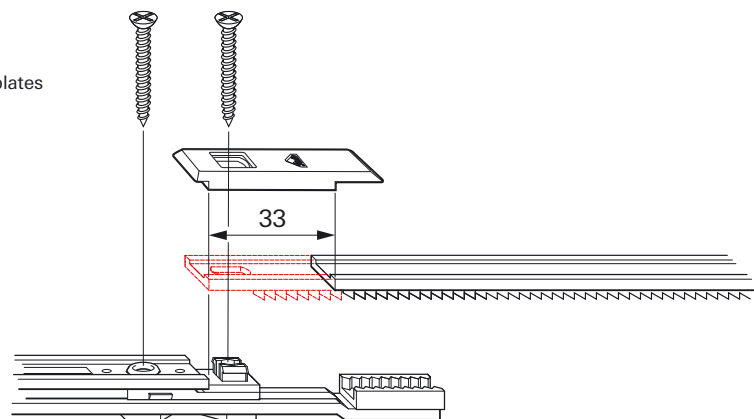

Hinging and unhinging the sash

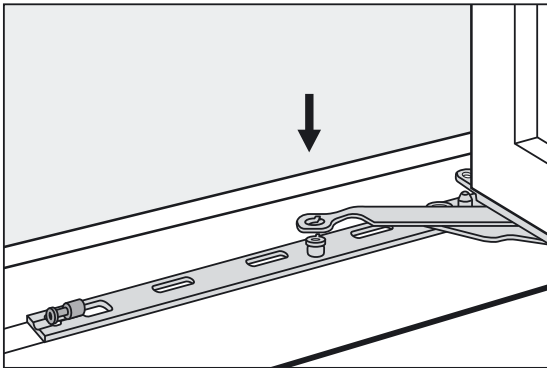

Pivot rest R

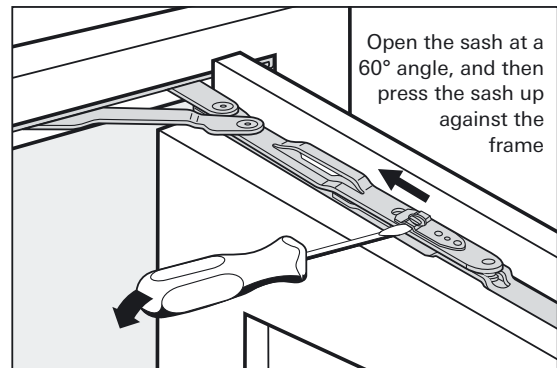

Stay arm R

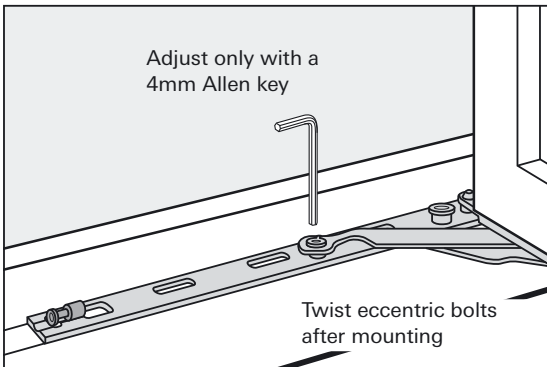

Pivot rest R

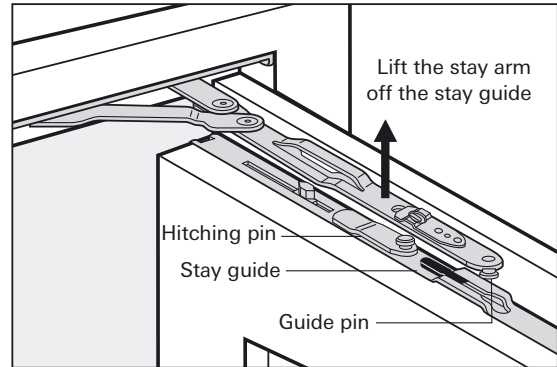

Stay arm R

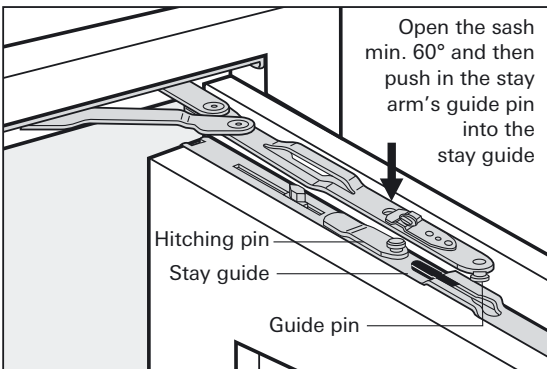

Stay arm R

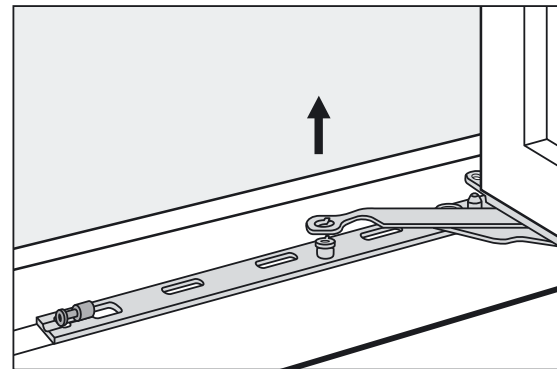

Pivot rest R

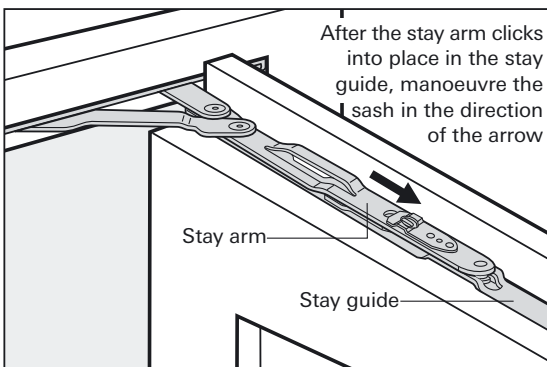

Stay arm R

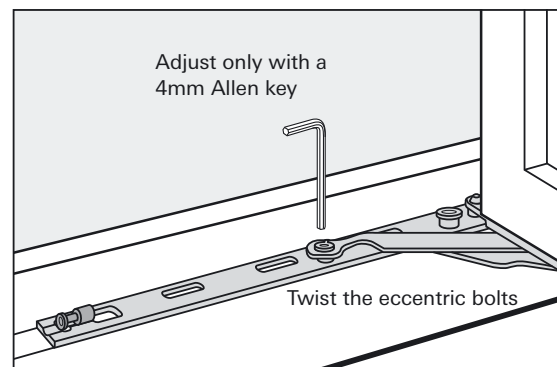

Pivot rest R

Roto NT

Adjustments

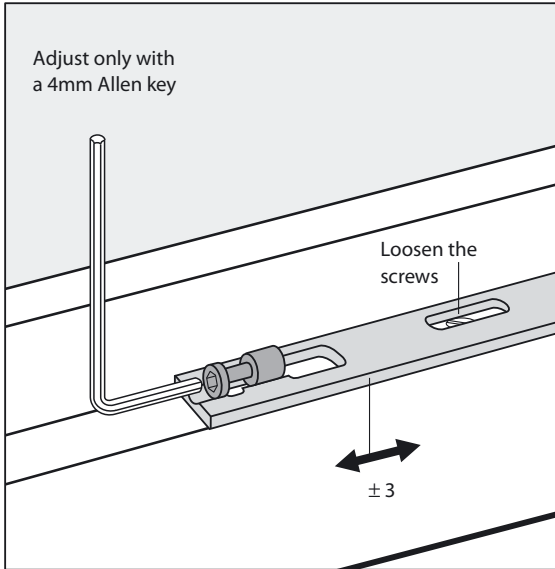

Pivot rest R

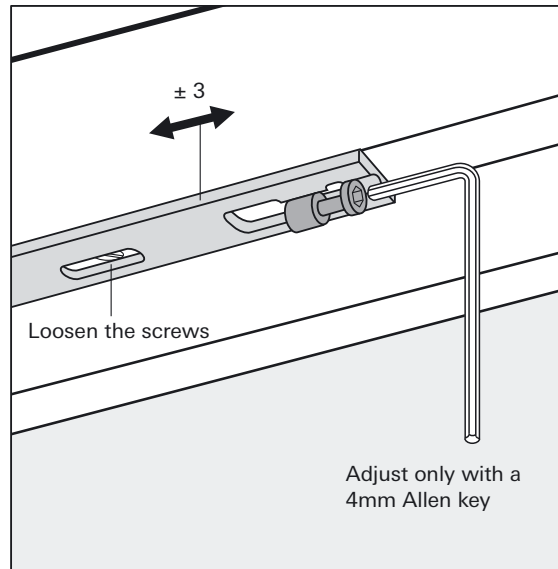

Stay arm R

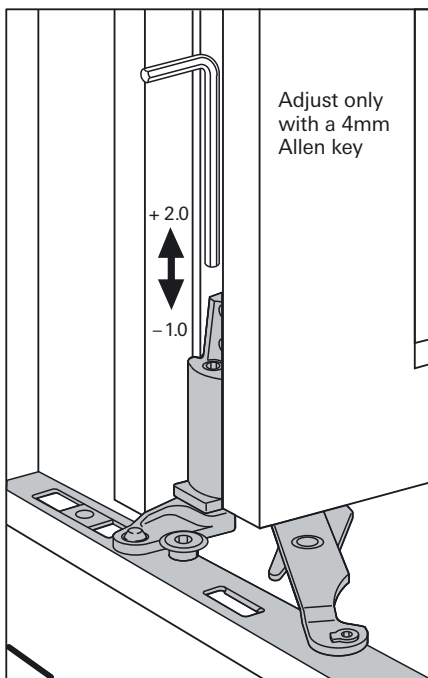

Corner hinge R

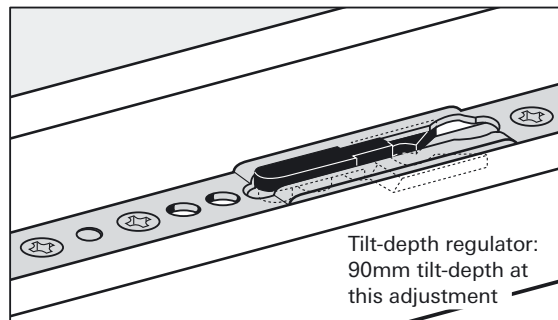

Integrated tilt-depth regulators on stay guide R, size 250.

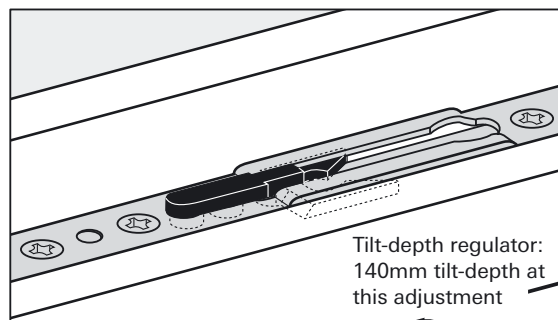

Anti-slam device integrated in the stay guide R

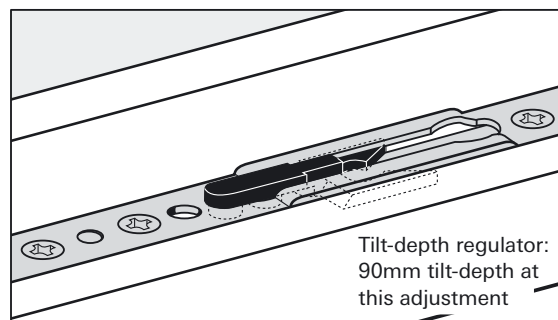

Integrated tilt-depth regulators on stay guide R, size 450.

Locking cam options and adjustment



Locking cam E	Adjustment range in °	Gasket compression adjustment in mm
	Original position 	-
	 90° 90°	+/- 0.8

Locking cam P	Adjustment range in °	Gasket compression adjustment in mm
	Original position 	-
	 90° 90°	+/- 0.8

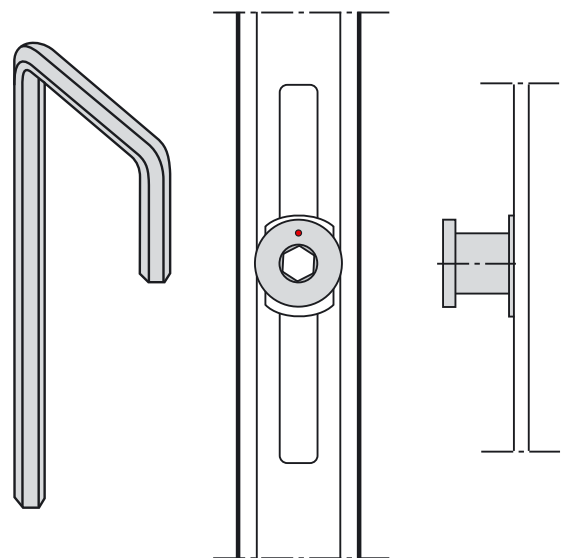
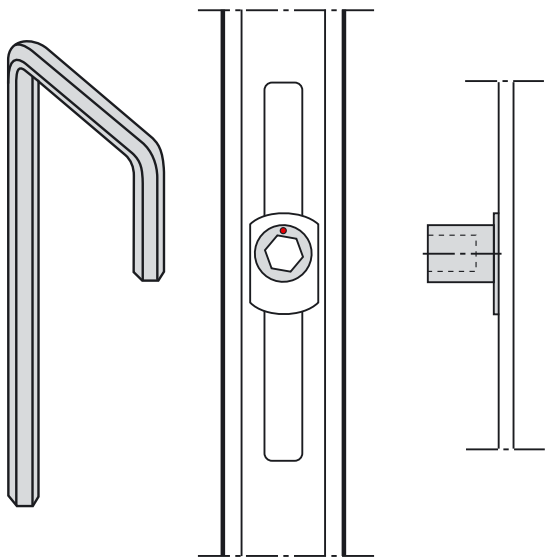

Locking cam V	Adjustment range in °	Gasket-compression adjustment in mm	Height adjustment in mm
		-	
V cam adjustment tool 258 191	Original position 	-	-
	 90° 90°	+/- 0.8	+/- 0.2
	 180° 180°	-	+/- 0.4
	 270° 270°	+/- 0.8	+/- 0.6
	 360° 360°	-	+/- 0.8

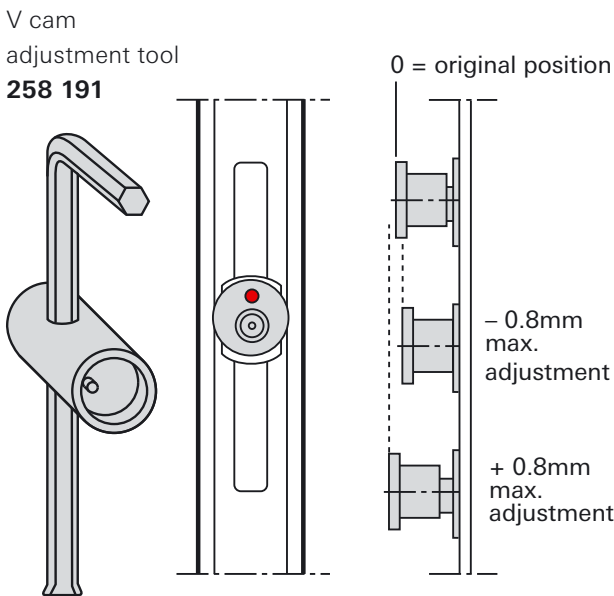

Roto NT

Maintenance

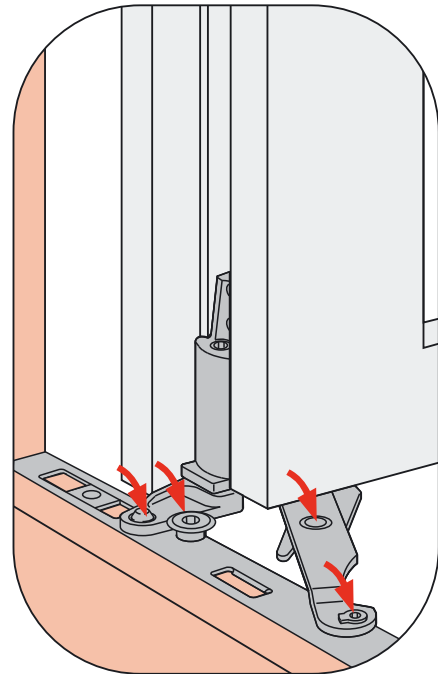
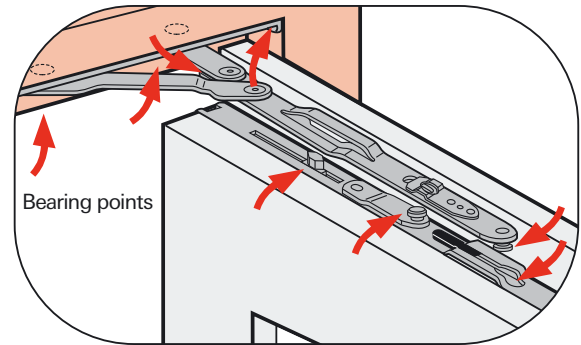
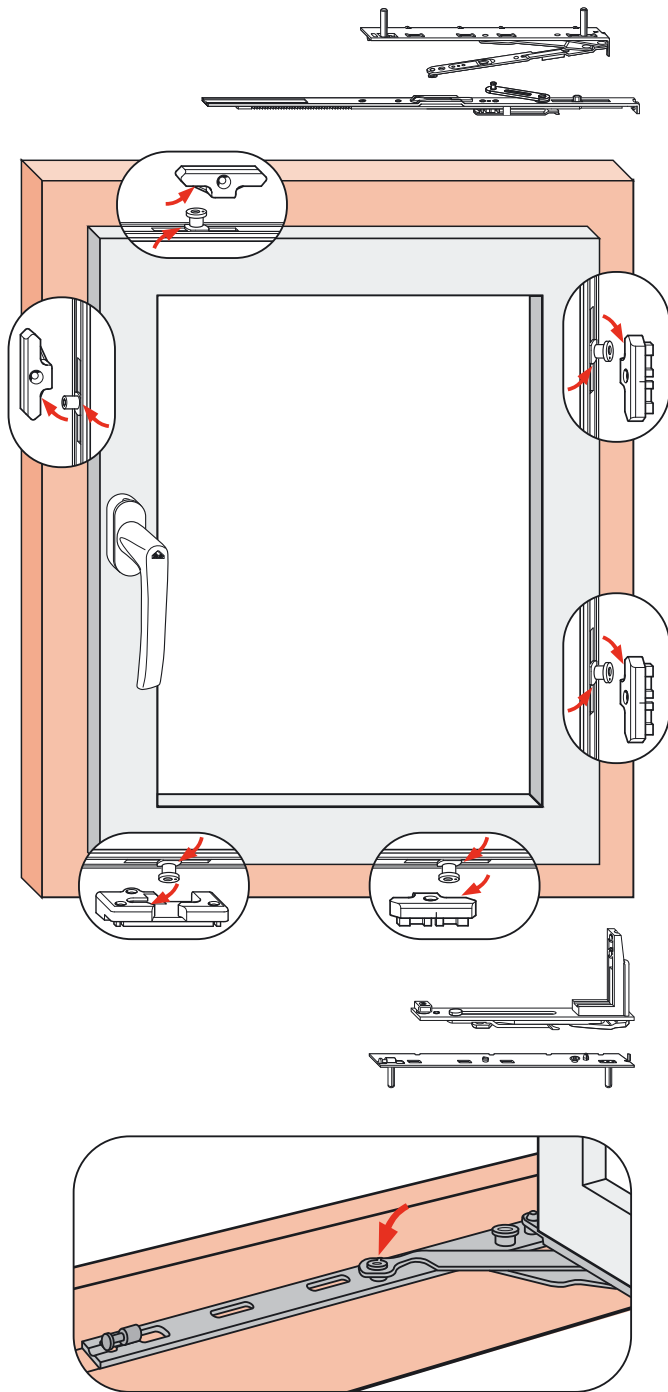

Maintenance



By means of regular **greasing and oiling*** (at least once a year) all operation-relevant components in the sash and frame, you maintain the smooth operation of your Roto hardware and you protect against premature wear and tear. Security strikers made of steel require continuous greasing in

order to avoid unnecessary abrasion. In addition, the individual screws are to be checked. Possible loose screws or broken off screw-heads are to be tightened or replaced immediately by a specialised company.

* Please use acid free and non-resinous grease and/or oil from a specialised dealer.

Operating and safety instructions



Operation

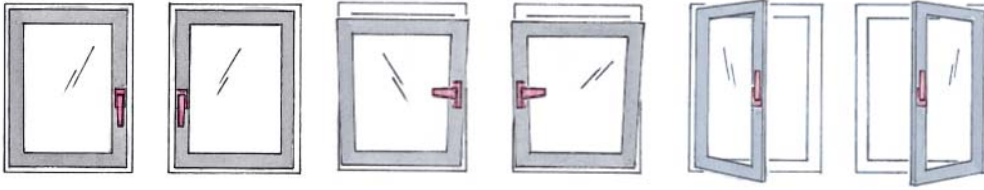

Avoid mishandling

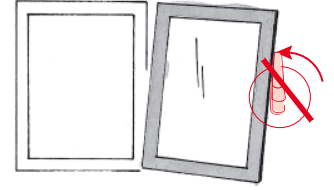

The window must be closed before switching to the open (turn) mode to avoid mishandling.

In order to preserve **functionality** of your window and to guarantee **security**, it is imperative the directives listed below are observed.

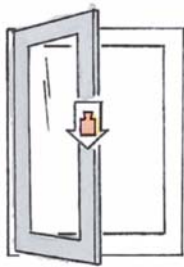

The window sash may not be burdened with additional weight.

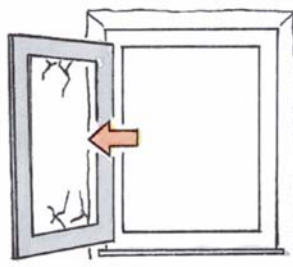

Do not allow the sash to hit or press up against the window reveal.



Do not place any objects between the sash and frame.



Where small children or mentally handicapped persons have access to the window, the sash is to be safeguarded against turning, for example with a child-safety lock (inhibits turn mode, permits tilt-mode) or key-lockable handle.



Do not leave sashes open in the turn mode during strong winds.



Caution! A slamming sash can lead to injuries. While closing, do not grasp between the sash and frame.

COMPETENCE WITHOUT BOUNDARIES

International:

Germany

Roto Frank AG
Headquarters
Stuttgarter Strasse 145-149
Leinfelden-Echterdingen
Tel +49 711 7598-0
Fax +49 711 7598-253
E-mail info@roto-frank.com
www.roto-frank.com

Germany

Roto Frank AG
Velbert Factory
Siemensstrasse 10
42551 Velbert
Tel +49 2051 203-1
Fax +49 2051 230-251

Belgium

S.A. Roto Frank N.V.
Rue du Bosquet 1
Zoning Industriel II
1400 Nivelles
Tel +32 67 894140
Fax +32 67 841456
E-Mail info.bel@roto.be

Peoples Republic of China

Beijing Roto Frank Building
Materials Co., Ltd.
Xindudongzhan,
East of Xisanqi, Haidian District
100096, Beijing
Tel +86 10 82950045/46
Fax +86 10 82920115
E-Mail info.china@roto-frank.com

France

Roto Frank Ferrures S.A.S.
Zone Industrielle
1, rue Wilhelm Frank
57380 Faulquemont
Tel +33 3 87292440
Fax +33 3 87292444

Netherlands

Roto Frank B.V.
Dorpsstraat 134
3991 BZ Houten
Tel +31 30 6385550
Fax +31 30 6342840
E-Mail info.nl@roto-frank.com

Austria

Roto Frank
Eisenwarenfabrik AG
Lapp-Finze-Strasse 2
8401 Kalsdorf
Tel +43 3135 504-0
Fax +43 3135 52727

Poland

Roto Frank
Okucia Budowlane Sp z oo
Wal Miedzeszynski 402
03-994 Warsaw
Tel +48 22 87216-00/-04
Fax +48 22 87216-11
E-Mail info.pl@roto-frank.com

Romania

Roto Romania S.r.l.
Calea 13 Septembrie, Nr. 226
Bl. V54, Sc. 1, Ap. 10, Sect.5
7000 Bucharest
Tel +40 21 4114186
Fax +40 21 4114186
E-Mail info.ro@roto-frank.com

Russia

Roto Frank AG
Kosmodamianskaja nab. 52,
Geb. 1
113054 Moscow
Tel +7 095 96124-27/-30
Fax +7 095 96124-31
E-Mail info@roto.ru

Switzerland

Roto Frank AG
Bernstrasse 390
8953 Dietikon
Tel +41 1 7458555
Fax +41 1 7458556
E-Mail info@roto.ch

Spain

Roto Frank S.A.
Pol. Industrial Molí de les Planes
Parcela No. 37
08470 Sant Celoni (Barcelona)
Tel +34 93 8675720
Fax +34 93 8675845
E-Mail info.sp@roto-frank.com

Turkey

Roto Frank Ltd. Sti.
Alemdağ Cad.
Site Yolu No. 10
34768 Ümraniye - Istanbul
Tel +90 216 412-0901
Fax +90 216 412-0903
E-Mail info.tr@roto-frank.com

Hungary

Roto Elzett
Vasalatkereskedelmi Kft.
9461 Lövö
Kossuth u. 25
Tel +36 99 534-400
Fax +36 99 367-132
E-Mail info.hun@roto-frank.com

USA

Roto Frank of America, Inc.
Hardware Systems & Roof
Windows, Research Park
Chester, CT 06412
Tel +1 860 526 4996
Fax +1 860 526 8390
E-Mail info.usa@roto-frank.com

International representatives:

Estonia

Roto Frank Ehitusrautised OÜ
Peterburi tee 81-512
11415 Tallinn
Tel +372 632 6980
Fax +372 632 6980
E-Mail roto@uninet.ee

Greece

Eurotechnica
Industrial area of Thessalonica A7
O.T. 18 Nr. 34
57022 Sindos/P.O. Box 198
Tel +30 310 796950
Fax +30 310 796783
E-Mail eurotech@eurotechnica.gr

Italy

SARI S.r.l.
Via delle Industrie 2, no. 8
30020 Meolo (VE)
Tel +39 0421 618611
Fax +39 0421 618455
E-Mail info@sarimeolo.com

Italy

Tekno System S.r.l.
Zona Industriale
SS 89 Km. 9,800
71011 Apricena (FG)
Tel +39 0882 647671
Fax +39 0882 647669
E-Mail info@teknoroto.it

Slovenia

Roto Lož d.o.o.
Cesta 19. oktobra 52
1386 Stari trg pri Ložu
Tel +386 1 7095-100
Fax +386 1 7095-190

Czech Republic

Roto Nové Město
Kříčková ulice 373
59231 Nové Město na Moravě
Tel +420 566 652411
Fax +420 566 652413
E-Mail nove.mesto@roto-nm.cz

Ukraine

Roto Frank AG
ul. Marina Raskowoj, 17-612
02002 Kiev
Tel +380 44 5595905
Fax +380 44 5595905
E-Mail rotokiev@adamant.net

Belarus

Roto Frank AG
ul. Woronjanskogo, 7a
220039 Minsk
Tel +375 17 2281286
Fax +375 17 2281428
E-Mail rotominsk@tut.by

Roto Frank Ltd

Swift Point • Rugby • Warwickshire • CV21 1QH

Telephone: 01788 558600 • Facsimilie: 01788 558605

E-Mail: uk_sales@roto-frank.com • Internet: www.roto-frank.co.uk

