

Roto DoorSafe

Twist Bolt Door Lock for Timber



DoorSafe Twist Bolt



Liability exclusion

All specifications in this catalogue were compiled carefully and reviewed. Because of technical progress and legislation modifications, the data may have changed in the meantime. We therefore hope you shall understand that we cannot be held liable for the correctness, completeness, and topicality of the contents. All rights, in particular the right to copy and circulate, reserved.

Imprint

Copyright: January 2009
Roto Roof Windows and Hardware Ltd
Swift Point
Rugby
CV21 1QH
Telephone: +44 (0)1788 55 86 00
Telefax: +44 (0)1788 55 86 05
info.west@roto-frank.com
www.roto.co.uk

Product liability and warranty	4
General design description	5
Operation	6
Diagram key and handing information	7
H500 T / H541 T - easy2escape	8
Twist bolt - technical information and routing detail	9
H500 & H541 - lock centre detail	10
Timber strikers	11

According to the defined manufacturer's liability described in paragraph 4 of the "product liability law", the following information regarding locking hardware systems for doors made of timber, PVC or aluminium should be observed. Non-compliance exempts the manufacturer from liability.

1. Product information and stipulated application

Locking hardware systems as covered by this definition is hardware for vertically installed doors made of timber, PVC or aluminium and their corresponding material combinations, which mainly have the task of closing and locking doors.

What is meant by closing, is that the door is held in such a manner that it cannot be opened by means of draught or pressure, however can be opened easily with a lever-handle. The latch is used for closing.

What is meant by locking is that the closed door is secured by means of a non-spring loaded, rigid bar and/or via two or more additional locking points: i.e. cams or bolts.

All locking devices engage into corresponding recesses in the door frame, and/or strikers, lock casing etc. The locking function is carried out by the dead-bolt and/or the additional locking devices (for example cams or bolts).

The deadbolt and the additional locking devices are moved by means of turning the profile cylinder key and/or by activating the lever-handle in order to lock and unlock.

The locking systems are designed for profile cylinders and/or round cylinders.

Refer to the technical documentation of these locking systems for the necessary dimensions and requirements for these cylinders.

The locking systems are not suitable for deformations and modifications of the final sealing-closure as a result of differences in temperature or building modifications.

The respective entire hardware set (locking system) may only consist of Roto original hardware components.

Damage can arise from the use of non-Roto hardware components, which excludes any liability on our part. To ensure stipulated application, the correct combination of permissible hardware and locking appliances is required (i.e. keys & cylinders), as well as accessories (i.e. strikers) and their installation, according to DIN-standards and maintenance requirements.

Doors for damp rooms and for use in environments with aggressive, corrosive air-content require special hardware. Mandatory legal regulations must be adhered.

2. Misuse

Misuse – therefore not the stipulated product utilisation of locking systems occurs if:

- the use of a non-Roto or non-stipulated part in the locking system or striker-plate prevents perfect operation.
- obstacles are inserted in the opening vicinity, thus preventing its proper specified use.
- a burglary attempt is carried out on the locking system or striker, which results in a modification of the construction, or affects its function.
- in order to keep the door open, the protruding shootbolts and/or the locking devices have been incorrectly operated.
- the locking devices have been mounted incorrectly or have been retro-treated, for example, painted.
- manual force, exceeding the normal force, has been applied on the lever-handle.
- manual force, exceeding the normal force, has been applied to the locking system via the profile cylinder key.
- non-relevant locking appliances, for example with differing dimensions, have been used.
- an enlargement or reduction of the required door gap arises while adjusting the butt hinges or door.
- a non-specified 2-leafed door has been opened via the passive leaf.
- a simultaneous lever-handle and cylinder operation takes place.
- tools or lever-effective aids have been used to operate the locking system.
- additional loads are exerted on the door leaf.
- while closing the doors someone reaches between door leaf and frame. (risk of injury!)

3. Liability

The entire hardware set may only consist of hardware components from Roto Frank AG. In the case of inappropriately assembled hardware, and/or in case of non original accessory components and/or non factory-approved accessory components, no liability is accepted.

4. Product performance

If the product performances have not been specifically determined in our catalogues and brochures, the requirements of the individual locking system must be agreed upon with us.

The adequacy of the locking systems is dependent, amongst other things, on operational frequency, operational manner, environmental influences and maintenance.

The locking cylinder and key are to be replaced as soon as malfunctions occur in particular while inserting or pulling out the key, in spite of proper maintenance.

Combination of the hardware:

The manufacturers regulations that deal with the combination of hardware are obligatory – (for example: the order of lever-handles, cylinders or additional hardware components)

5. Product maintenance

Security relevant hardware components are to be regularly examined for stability and wear and tear.

Subject to the requirements, the fixing-screws are to be tightened and/or parts replaced.

In addition to this, – according to demand – the following maintenance work is to be carried out annually:

- All movable parts and all locking points of the system are to be greased and tested.
- Only cleaning and maintenance agents that do not damage the corrosion protection of the hardware components are to be used.
- Work on the locking systems and corresponding hardware components, as well as the replacement of parts, is to be carried out by a specialist company.

6. Obligation to issue information and instructions

The following documentation is available to planning engineers, authorised dealers, fabricators, builders and users in conjunction with our obligation to issue information and instructions, as well as for maintenance work according to the "product liability code"

- Planning documents
- Catalogues
- Installation instructions
- Maintenance and care instructions
- Operating manuals

In order to ensure the perfect function of locking systems for doors

- Planning engineers are obliged to request and comply with the manufacturer's product information.
- The specialised dealers are obliged to observe and request product information from the manufacturer and to pass this on to the fabricators, in particular installation instructions, service & maintenance instructions as well as operating manuals.
- Fabricators are obliged to observe the product information and in particular to request service & maintenance instructions as well as operating manuals from the manufacturer.

7. Application of related hardware

The possible variations within the individual locking systems are to be treated according to the corresponding valid features of product performance, product maintenance, information and instruction obligations, product information, specified use/application and misuse.

Faceplate

- 20mm x 3mm with radiused ends
- Roto Sil (silver finish) for high corrosion resistance in accordance with **BS EN 1670:2007 part 5.6, grade 5** - 480 hours building hardware corrosion resistance.

Main lockcase

- 92mm keyhole distance (pz), steel lockcase
- Left hand and right hand application
- Lever/lever and egress options (500/541)
- Sprung latch
- 20mm deadbolt throw with twin, hardened steel pins for cutting protection
- Single turn of the key to deadlock

Additional lockcases

- Steel lockcase housing unique **Twist Bolt** technology
- 20mm T-Bolt throw
- Strong construction - 11mm diameter steel bolt
- T-Bolt is thrown and turned with a single movement of the handle, creating compression and security

Strikers

- Adjustable +/- 2mm, latch
- T-Bolts, remove and rotate for adjustment
- Diagonal grain fixings for superior "pull out" strength and maximum security
- Three piece latch plate with deadbolt protection

Accreditations

- Tested to SKG 

H500 - lever/lever

Inside / outside locking

By simply lifting the lever upwards the central deadbolt and t-bolts are thrown. By turning the key in the cylinder the mechanism is then deadlocked.

Inside / outside unlocking

Turn the key in the cylinder, this operation releases the mechanism. Then simply depress the handle.

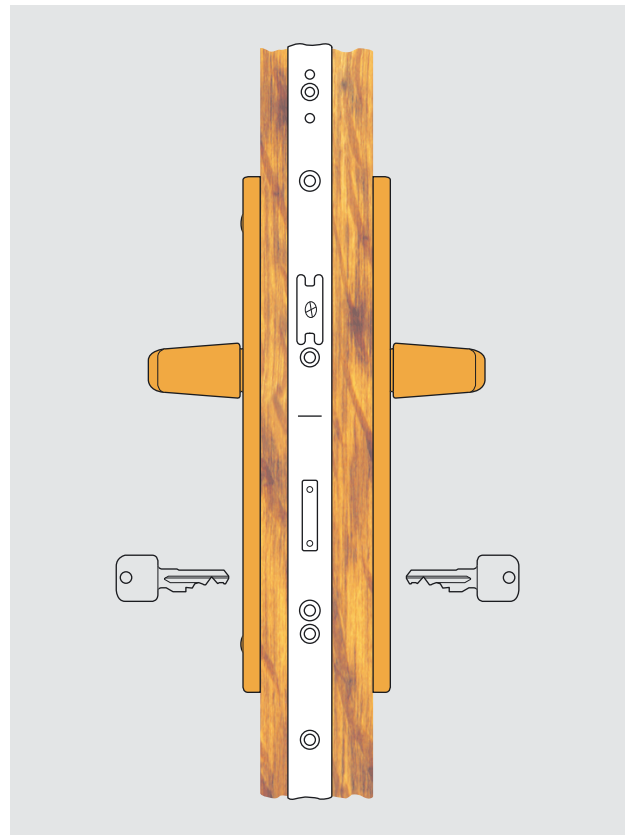

H541 - lever/lever with split spindle - easy2escape

This lock has an automatic deadlocking function and quick escape.

By simply lifting the lever upwards the central deadbolt and t-bolts are thrown and deadlocked.

To unlock and open from the inside, simply depress the handle. The t-bolts, deadbolt and latch are retracted.

To unlock and open from the outside the key must be turned in the cylinder and the handle depressed, retracting the t-bolts, deadbolt and latch.

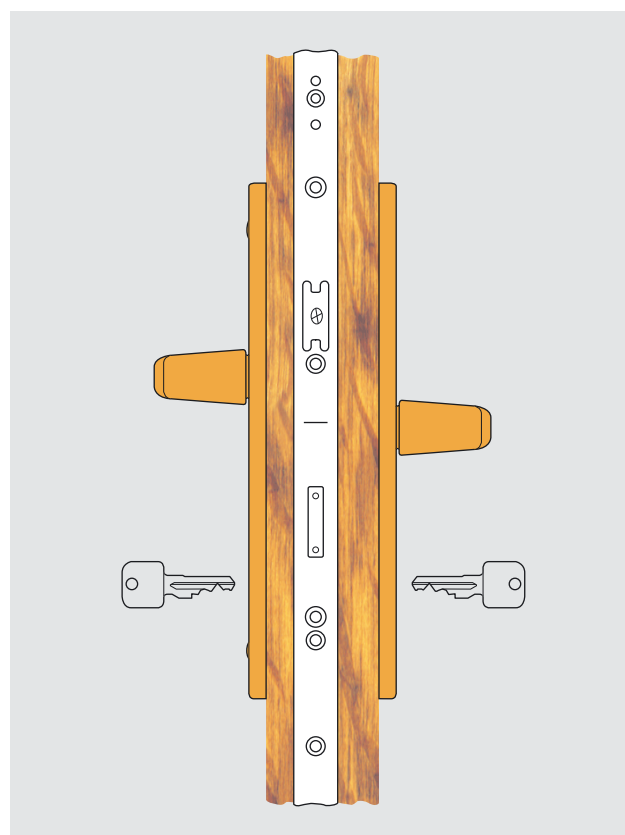

Abbreviations used

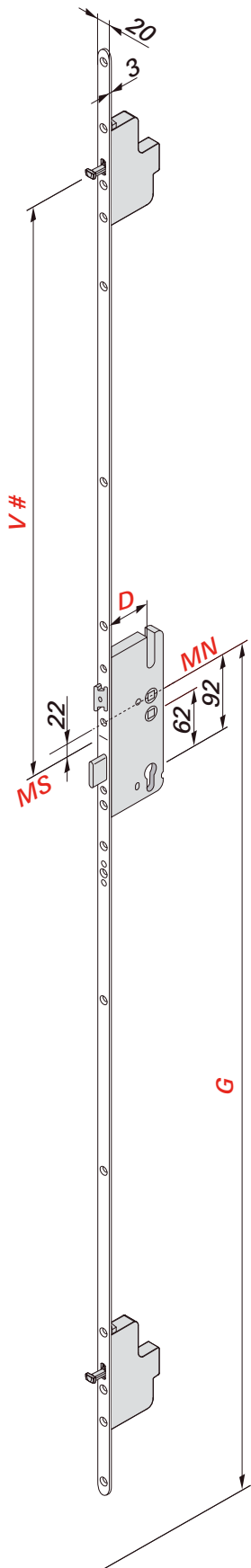

General abbreviations

H500	Handle operated, multi-point locking system
H540	Automatic deadlocking - easy2secure
H541	Automatic deadlocking - easy2escape
T	Twist bolt

Abbreviations in the tables

D	Backset
G	Handle height
⊙	Spindle
O	Surface finish ROTOsil - SL
V#	Locking points
SRH	Sash rebate height

Abbreviations in the diagrams

D	Backset with 3mm faceplate
G	Handle height
MS	Lock case centre
MN	Spindle centre
V#	Locking points

Handing information

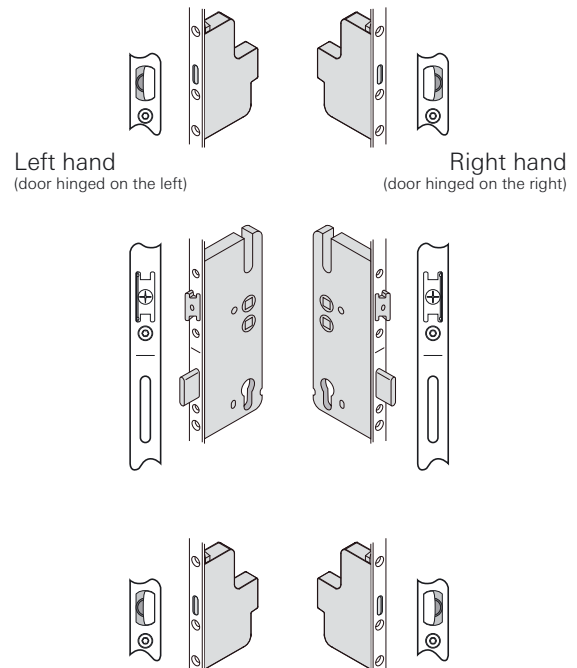

H500 T

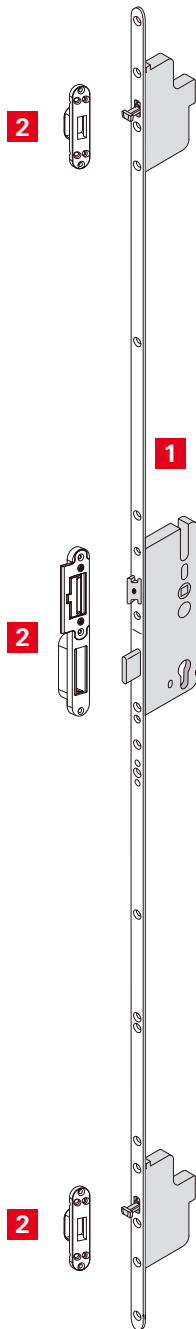

H541 T - easy2escape

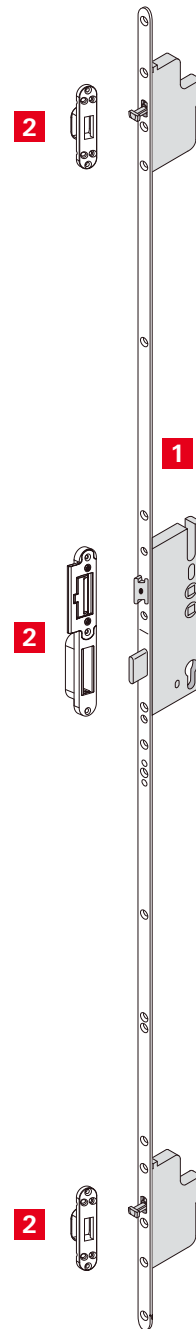

1 Faceplate length 1744 - 3x20mm
Sash rebate height 1760 - 2200mm

D	E	⊘	G	O	Part code
55	92	8	1050	Sil	376370 LH
55	92	8	1050	Sil	376371 RH

1 Faceplate length 1744 - 3x20mm
Sash rebate height 1760 - 2200mm

D	E	⊘	G	O	Part code
65	92/62	8	1050	Sil	469690 LH
65	92/62	8	1050	Sil	469691 RH

2 Strikers

Latch & deadbolt striker (latch run-up 30mm)	373291
Latch & deadbolt striker (latch run-up 47mm)	373290
Twist bolt strikers	373295

2 Strikers

Latch & deadbolt striker (latch run-up 30mm)	373291
Latch & deadbolt striker (latch run-up 47mm)	373290
Twist bolt strikers	373295

H500 detail

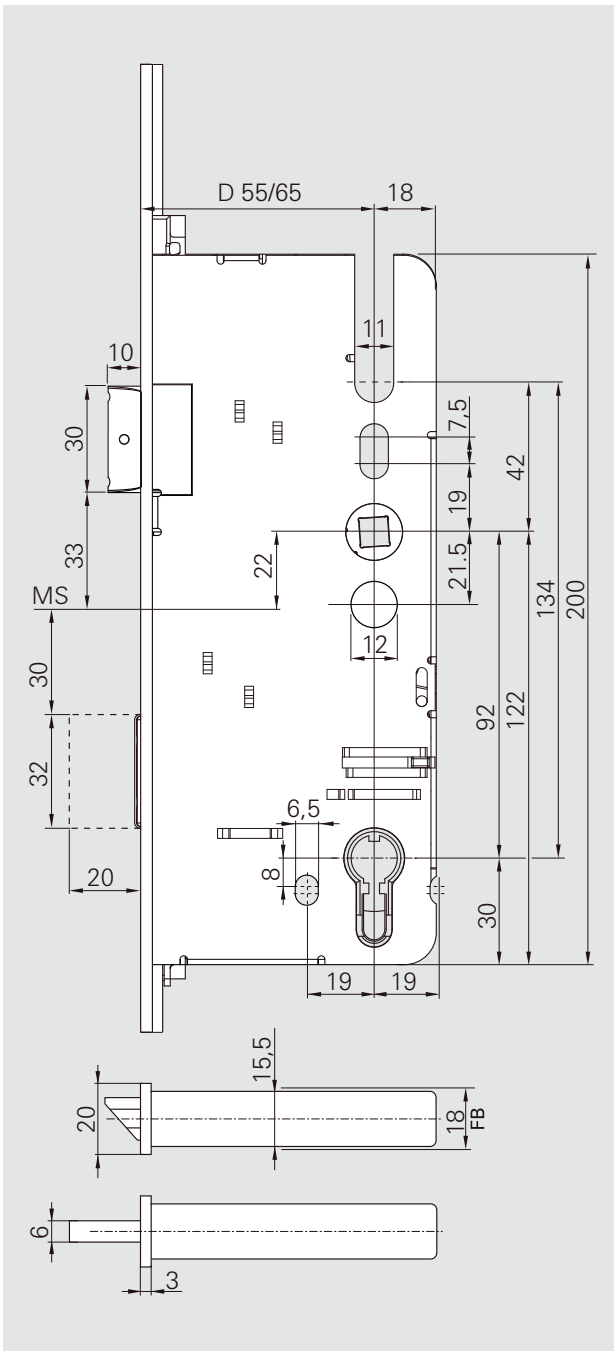

H541 detail

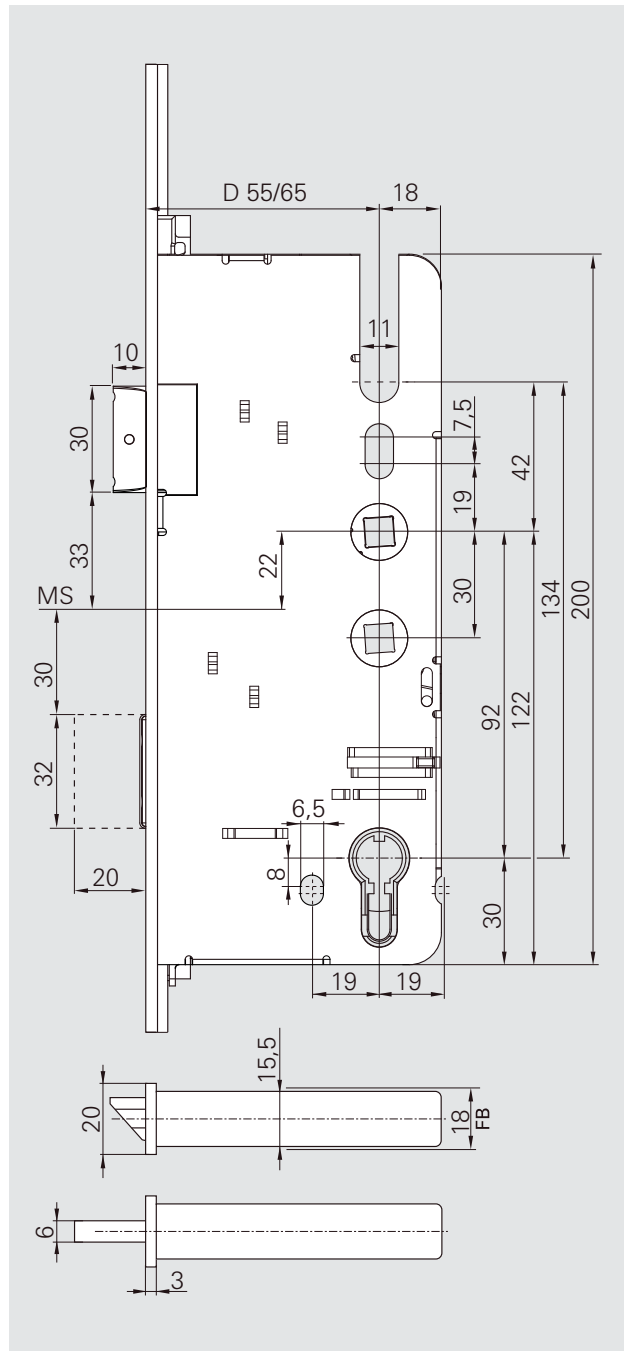

Timber strikers

Latch & deadbolt striker - latch run-up 30mm

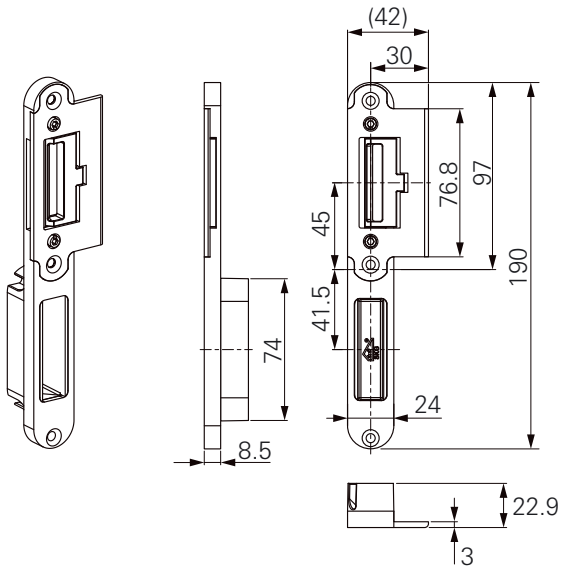

Latch & deadbolt striker - latch run-up 47mm

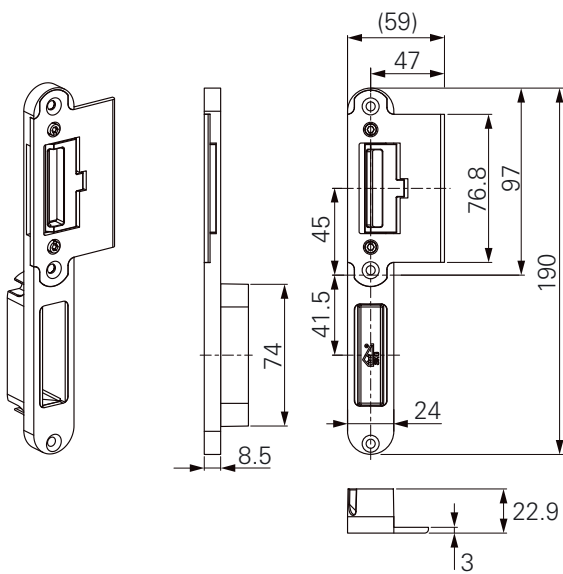

Twist bolt striker

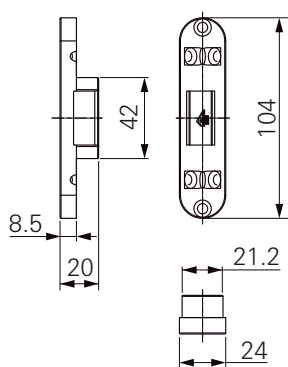



Roto Roof Windows and Hardware Ltd.

Swift Point
Rugby CV21 1QH
United Kingdom
Telephone +44 (0)1788 55 86 00
Facsimile +44 (0)1788 55 86 05
info.west@roto-frank.com
www.roto-frank.co.uk

**Roto Frank S.A.
Roto Frank Nederland**

Rue du Bosquet 1
Zoning Industriel II
1400 Nivelles
Belgique
Téléphone +32 (0)67 89 41 40
Téléfax +32 (0)67 84 14 56
info.west@roto-frank.com
www.roto-frank.com

**Roto Frank AG
Fenster- und Türtechnologie**

Stuttgarter Straße 145 – 149
D-70771 Leinfelden-Echterdingen
Telefon +49 711 7598-0
Telefax +49 711 7598-253
info@roto-frank.com
www.roto-frank.com



Interested in additional products?

Do not hesitate to ask for further information

Telephone number:
+44 (0)17 88 55 86 00